

ITEM NO.	PART NUMBER	DESCRIPTION	DRAWING #	QTY.
1	FP-TLP625	PLUNGER, CAM LOCK	15-1407	1
2	FP-AE-RRTS-GST	RAILROAD TIE ARM SPINNER GUSSET	90-2300	2
3	RE-PN-C1x475	PIN, CON, 4-7/8"	10-1707	1
4	ST-ST-3.5 x .1875 L 16	LENGTH: 16"	STOCK	1
5	ST-MT 2.625 x 2.0625 L 13 cut	LENGTH: 13"	STOCK	1

REV.	REVIISONS DESCRIPTION	DATE	APPROVED
A	INITIAL RELEASE	7/20/2012	
B	ADDED GUSSET	7/30/2012	

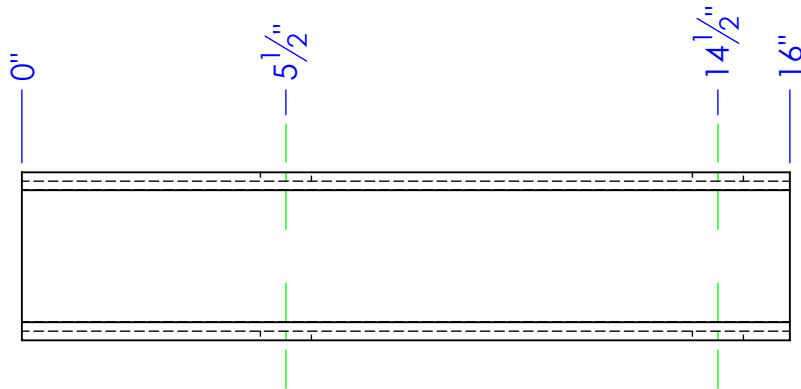

4
ST-ST-3.5 x .1875 L 16
LENGTH: 16"

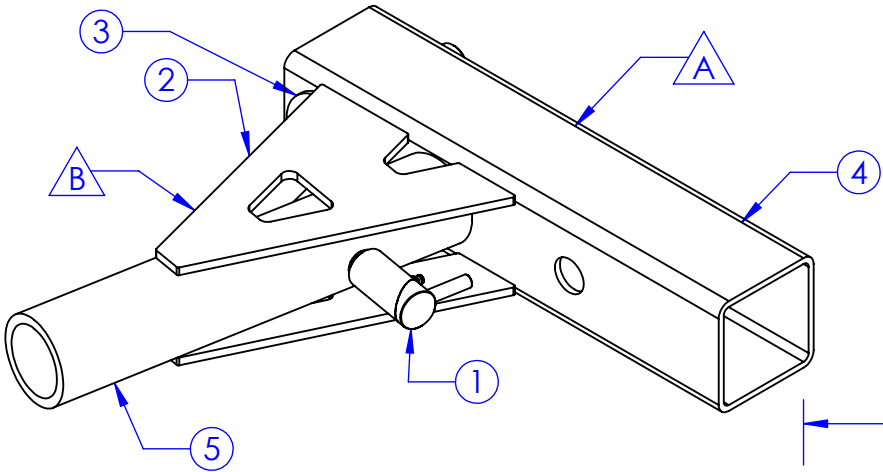
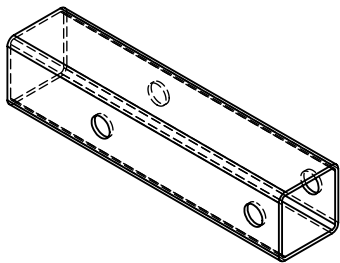

QTY: 2

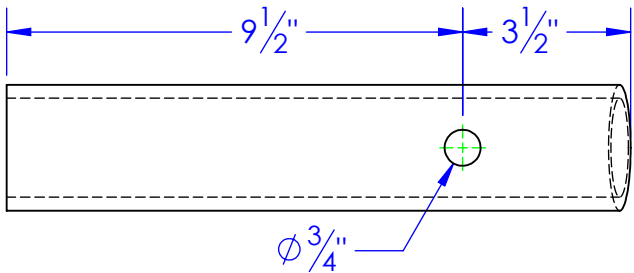
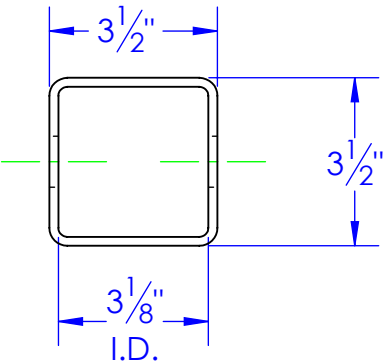
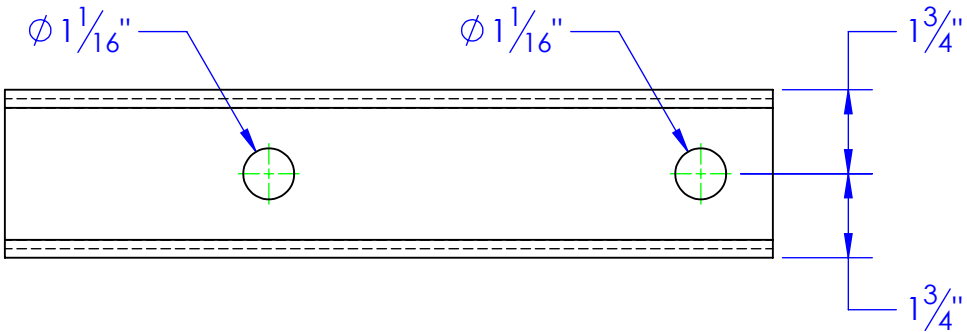
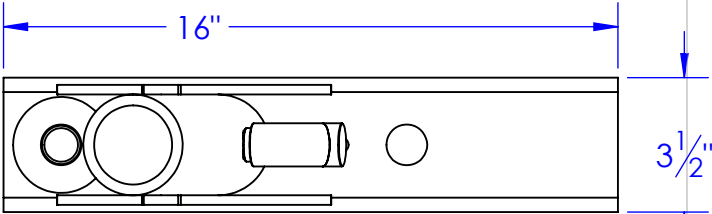
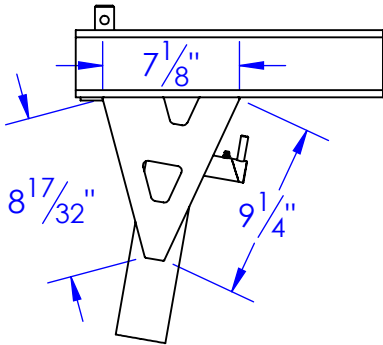

5
ST-MT 2.625 x 2.0625 L 13 cut
LENGTH: 13"

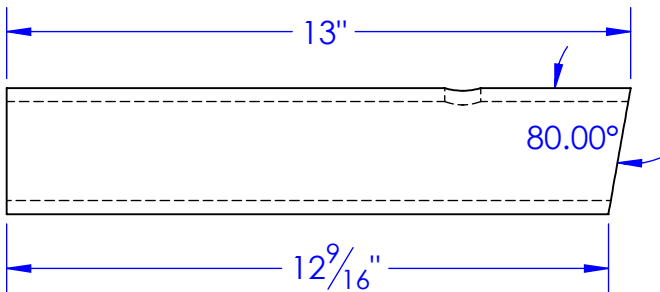
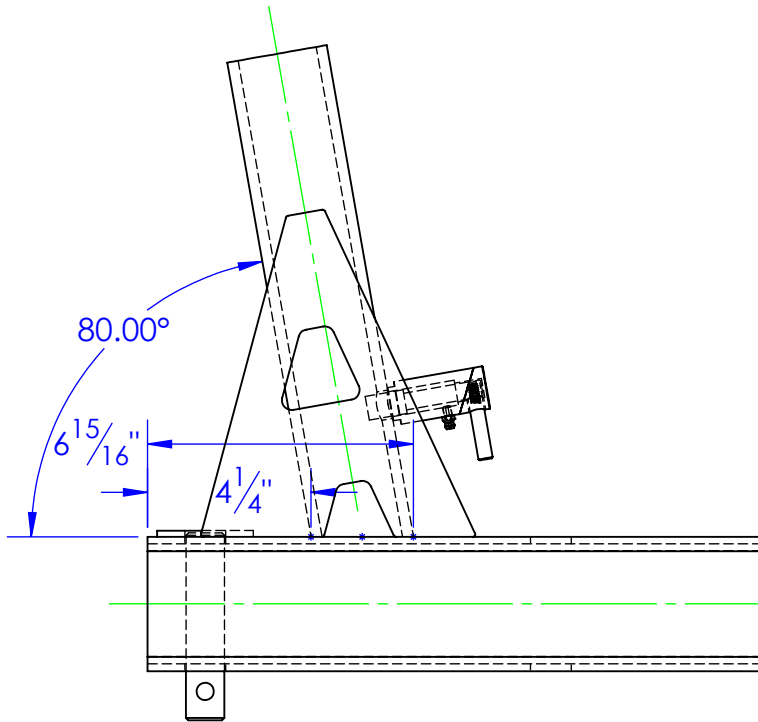
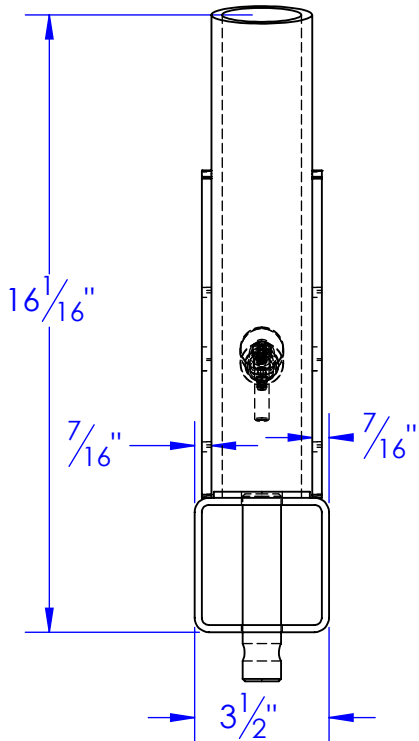
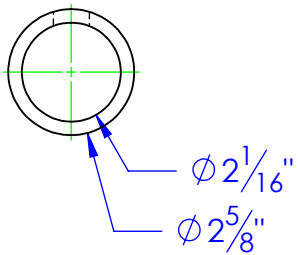
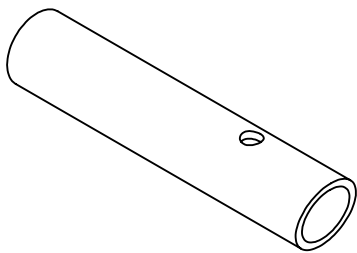

PROPRIETARY AND CONFIDENTIAL
THE INFORMATION CONTAINED IN THIS
DRAWING IS THE SOLE PROPERTY OF
<INSERT COMPANY NAME HERE>. ANY
REPRODUCTION IN PART OR AS A WHOLE
WITHOUT THE WRITTEN PERMISSION OF
<INSERT COMPANY NAME HERE> IS
PROHIBITED.

UNLESS OTHERWISE SPECIFIED:
DIMENSIONS ARE IN INCHES
TOLERANCES:
FRACTIONAL $\pm 1/16$
ANGULAR: MACH ± 1 BEND \pm
TWO PLACE DECIMAL ± 0.10
THREE PLACE DECIMAL ± 0.05
MATERIAL
DO NOT SCALE DRAWING

DRAWN	NAME	DATE	P.O. BOX 248, SABETHA KS. 66534 (785) 284-3674 FAX (785) 284-3931		
PART #	HEATH	7/30/2012	TRIPLE C INC.		
ASM #	OP-AE-RRTS-100 AE				
COMMENTS:			SIZE	DWG. NO.	REV
RAILROAD TIE SPINNER SLEEVE			B	90-1312 B	B
			SCALE: 1:5	WEIGHT: 24.12	SHEET 1 OF 1